

# PANETTONE HOLDER LAMP

It is recommended to use a rubber mallet for assembly.  
Follow the numbering indicated for proper assembly.



+39 080 322 1081

Toll-free number

+39 800 912 123

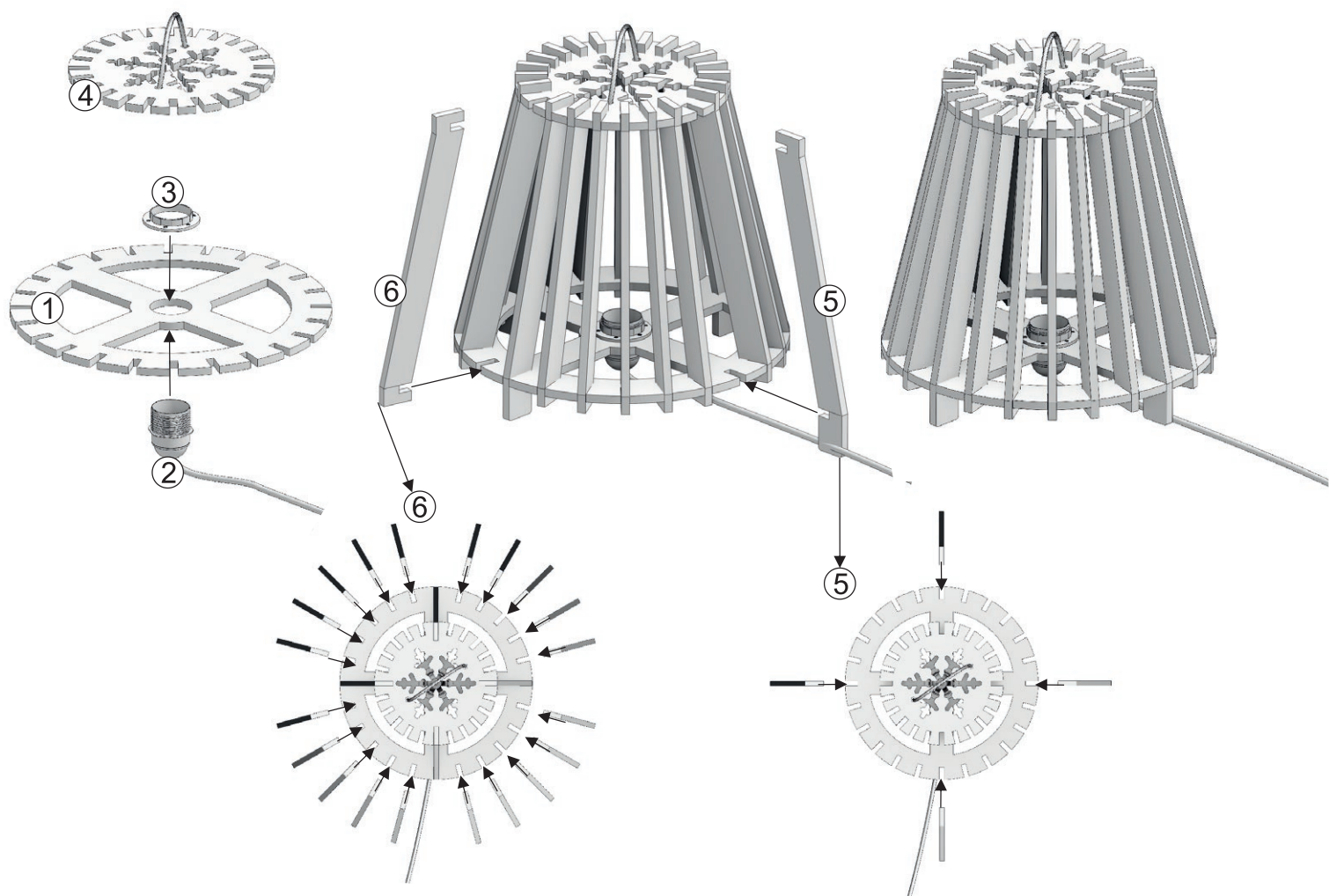

PRODUCED AND MADE BY EUROSUD CATALDI SRL - 70024 GRAVINA IN PUGLIA (BA) - ITALIA

**Wlalla**  
CREAZIONI IN LEGNO

  [info@wlalla.com](mailto:info@wlalla.com) - [www.wlalla.com](http://www.wlalla.com)

## WARNINGS

---

Carefully read the instructions provided before using the article.  
The manufacturer is not responsible if incorrect use of the item causes damage.  
Always keep the instructions handy for future reference.

- 1.** REMOVE ALL ITEMS FROM THE DISPLAY BEFORE MOVING IT.
- 2.** FLAMMABLE ITEM.
- 3.** DO NOT EXPOSE THIS ITEM TO ATMOSPHERIC AGENTS.
- 4.** USE DRY ELECTROSTATIC CLOTH TO CLEAN IT.
- 5.** DO NOT USE WATER OR DETERGENTS TO CLEAN THE ITEM.
- 6.** HANDLE WITH CARE.
- 7.** DO NOT USE FOOD ON THE ARTICLE AS IT COULD STAIN INDELIBLY.
- 8.** DO NOT WRITE OR COLOR ON THE ARTICLE AS IT COULD STAIN INDELIBLY.
- 9.** KEEP OUT OF REACH OF CHILDREN.
- 10.** DO NOT KEEP THE ITEM IN HUMID ENVIRONMENTS.
- 11.** THE ITEM COULD PRODUCE KNOCKS. IF A SPLIT GETS UNDER THE SKIN, CONTACT YOUR DOCTOR.
- 12.** DO NOT MODIFY THE SHAPE OF THE ARTICLE AS IT MAY BECOME UNUSABLE.
- 13.** KEEP PACKAGING AWAY FROM CHILDREN AND DISPOSE OF IT PROPERLY.
- 14.** IT IS RECOMMENDED TO USE APPROPRIATE GLOVES AND SHOES DURING THE ASSEMBLY PHASE.
- 15.** IN CASE OF BREAKAGE DO NOT USE THE ARTICLE AND DISPOSE OF IT PROPERLY.
- 16.** USE ONLY THE ACCESSORIES SUPPLIED WITH THE ARTICLE.